

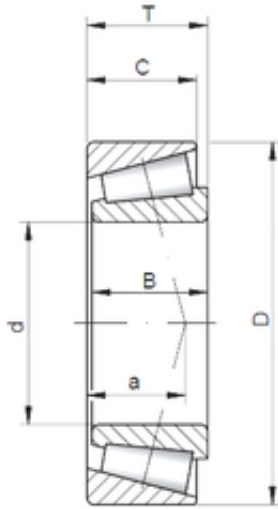

Bearing Electronic Instrument Co., Ltd.



ISO 42373/42584 tapered roller bearings

Bearing No. 42373/42584

Size	94.975x148.43x28.575 mm
Bore Diameter	94,975 mm
Outer Diameter	148,43 mm
Width	28,575 mm
d	94,975 mm
D	148,43 mm
T	28,575 mm
B	28,971 mm
C	21,433 mm
a	3 mm

42373/42584 Bearing 2D drawings and 3D CAD models