

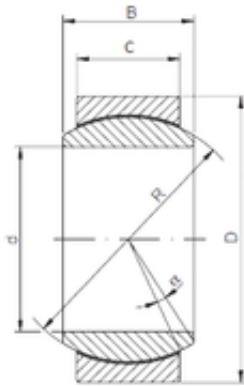

Bearing Electronic Instrument Co., Ltd.



ISO GE 025 ECR plain bearings

Bearing No. GE 025 ECR

Size	25x42x20 mm
Bore Diameter	25 mm
Outer Diameter	42 mm
Width	20 mm
d	25 mm
D	42 mm
B	20 mm
C	16 mm
R	35,5 mm
Angle	7 °

GE 025 ECR Bearing 2D drawings and 3D CAD models