

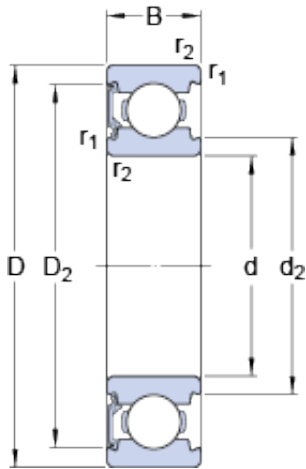

Bearing Electronic Instrument Co., Ltd.



6003-RSL Bearing 2D drawings and 3D CAD models

SKF 6003-RSL deep groove ball bearings

Bearing No. 6003-RSL

Size	35x17x10 mm
Bore Diameter	35 mm
Outer Diameter	17 mm
Width	10 mm
d	17 mm
D	35 mm
B	10 mm
d ₂	20.45 mm
D ₂	31.2 mm
r _{1,2} - min.	0.3 mm
d _a - min.	19 mm
d _a - max.	20.5 mm
D _a - max.	33 mm
r _a - max.	0.3 mm
Basic dynamic load rating - C	6.4 kN
Basic static load rating - C ₀	3.2 kN
Fatigue load limit - P _u	0.137 kN
Reference speed	45000 r/min
Limiting speed	28000 r/min
Calculation factor - k _r	0.025
Calculation factor - f ₀	14
Category	Single Row Ball Bearings
Inventory	0.0
Manufacturer Name	SKF
Minimum Buy Quantity	N/A



Bearing Electronic Instrument Co., Ltd.

Weight / Kilogram	0
Product Group	B00308
Enclosure	1 Seal
Precision Class	ABEC 1 ISO P0
Maximum Capacity / Filling Slot	No
Rolling Element	Ball Bearing
Snap Ring	No
Internal Special Features	No
Cage Material	Steel
Enclosure Type	Contact Seal
Internal Clearance	C0-Medium
Inch - Metric	Metric
Long Description	17MM Bore; 35MM Outside Diameter; 10MM Outer Race Width; 1 Seal; Ball Bearing; ABEC 1 ISO P0; No Filling Slot; No Snap Ring; No Internal Special Features; C0-Medium Internal Clearance; Steel Cage; C
Other Features	Deep Groove Low Friction NBR Seal
Category	Single Row Ball Bearing
UNSPSC	31171504
Harmonized Tariff Code	8482.10.50.68
Noun	Bearing
Keyword String	Ball
Manufacturer URL	http://www.skf.com
Weight / LBS	0.0901
Outer Race Width	0.394 Inch 10 Millimeter
Outside Diameter	1.378 Inch 35 Millimeter
Bore	0.669 Inch 17 Millimeter
Inner Race Width	0 Inch 0 Millimeter



Bearing Electronic Instrument Co., Ltd.

d_2	20.45 mm
D_2	31.2 mm
$r_{1,2}$ min.	0.3 mm
d_a min.	19 mm
d_a max.	20.5 mm
D_a max.	33 mm
r_a max.	0.3 mm
Basic dynamic load rating C	6.37 kN
Basic static load rating C_0	3.25 kN
Fatigue load limit P_u	0.137 kN
Calculation factor k_r	0.025
Calculation factor f_0	14
Mass bearing	0.039 kg